

# Roll-In Dock Assembly and Owner's Manual

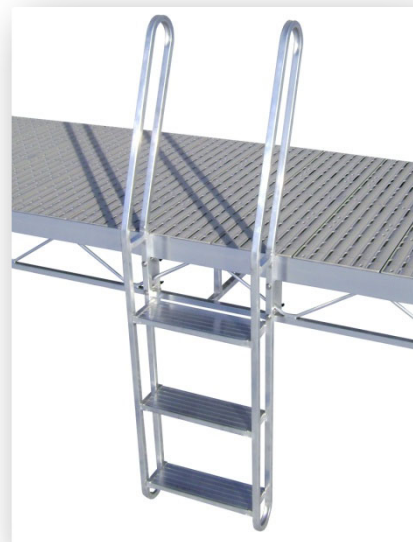

1270 N River Drive • Mankato, MN 56001  
Phone 800.658.7010 • [www.pierpleasure.com](http://www.pierpleasure.com)



**Register your Pier Pleasure purchase at  
[www.pierpleasure.com/warranty](http://www.pierpleasure.com/warranty)**

# ROLL-IN DOCK WARNINGS!

---

- Read and understand this manual completely before installing dock.
- Instruct everyone about the proper operating procedures.
- Level dock before using.
- Do not make any electrical connections to dock.
- Be sure to use cordless tools when near to or in water.
- Observe all caution stickers and decals. They are there for your safety.
- Always store vinyl and cedar panels on blocks of wood to keep off ground. This will prolong the life of the panels.
- To prevent risk of personal injury, do not lift or move dock alone. Be sure to use proper lifting techniques when assembling and moving dock.
- Be sure to tighten all bolts and brackets properly.
- It is recommended to lower the dock wheel kits to the lowest possible position before pushing / pulling dock from the water. This will prevent bending if wheel legs become hung up on a rock.
- Your Pier Pleasure limited warranty does not cover ice damage. Do not leave any Pier Pleasure product in the water during winter months. Leaving product in freezing water in all situations is not recommended and voids all warranties.
- Maximum Dock Load Capacity : 40 lbs. per square foot. Do not overload dock to prevent damage to frame and supports and to prevent risk of personal injury.
- Do not let any one play under or around dock. No jumping, diving or running on the dock. Severe head, neck, back injury or death could result. Wear Personal Floatation Device(PDF) for added protection when on the dock.
- Raise set screw leg posts and lower wheel kits before moving dock out of water. Remove all decking panels before moving dock.
- Inspect dock frame, panels, connections, nuts and bolts monthly for damage, wear and loose connections. Tighten or replace parts as needed.

Thank you for purchasing a Pier Pleasure Roll-In Dock System. We appreciate the confidence you placed in our products. If you need additional assistance beyond the information in this manual, please contact Pier Pleasure at 1.800.658.7010 or e-mail [info@pierpleasure.com](mailto:info@pierpleasure.com)

## **Tools Needed for Assembly and Installation**

- **1/2" Wrenches and/or Socket for 5/16" Bolts**
- **9/16" Wrenches and/or Socket for 3/8" Bolts**
- **3/4" Wrenches for 1/2" Bolts**
- **Pliers for Bending Cotter Pins**

# Table Of Contents

Assembling Sections with Standard Bolt Kit	Page 4
Single-Stage Connection System (Knobs)	Page 5
Dual-Stage Connection System	Page 6
Dock Connection Photos	Page 7
Connecting First L Section	Page 8
Connecting Second L Section	Page 9
12' Tube for Platform Support	Page 10
Connecting Corner Section	Page 11
Platforms and Corner Section & Wheel Kit Photos	Pages 12-13



## Optional Adjustment Crank (175-42000)

1-1/8" socket with handle to easily adjust height of the dock.

Straight Dock Wheel Kits	Page 14
L Dock Wheel Kits	Page 16
Set Screw Post Kits (Pair)	Page 18
Set Screw Post Kits (Single)	Page 19
Post Kit Wheel Kit	Page 20
Post Kit Photos	Page 21
4' x 4' Dock Ramp	Page 22
4' x 8' Dock Ramp	Page 23
Dock Ramps	Page 24

## Accessories Attached to Inside Track

Benches	Page 24
Benches with Arm Rests	Page 24
Bench Canopies	Page 25
Ladders	Page 25
Canoe Rack	Page 25

## Accessories Using Dock Accessory Bracket

4' Vertical Bumper	Page 25
Movable Cleat - Dock Railing - Dock Stairs	Page 26
Wind Sock Pole	Page 27
Fishing Rod Holder - Solar Lites	Page 28
Dock Furniture	Page 29

## Other Dock Accessories

Shore End Hitch – Corner Bumper	Page 27
Wedge Section	Page 29

Warranty	Page 30
----------	---------



1270 N. River Drive  
Mankato, Minnesota 56001  
Phone 800-658-7010  
Fax 507-388-6348

ITEM NO.	PART NUMBER	DESCRIPTION	QTY	
2	175-20050	Plate, Reinforcement	2	Bolt Kit : 175-40000
3	140-50-WL	1/2" SS Lock Washer	8	Bolt Kit : 175-40000
4	140-50-N	1/2" Brass Nut	8	Bolt Kit : 175-40000
5	140-50-15-B	1/2" x 1-1/2" Hex Head Bolt	8	Bolt Kit : 175-40000

## Standard Connection

This bolt kit comes with each section.

Connecting 2 Sections together end to end.

See photos on page 7.

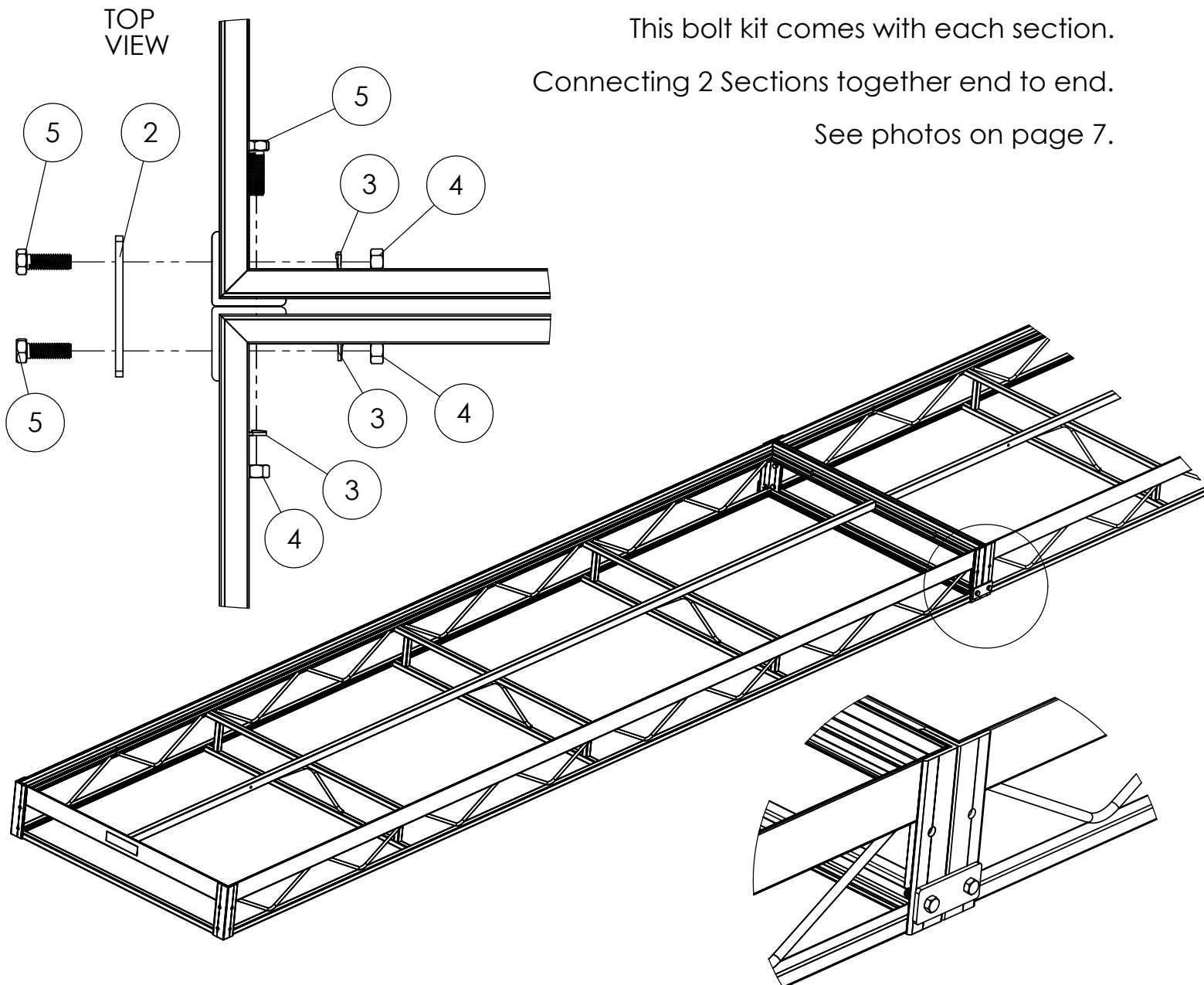



1270 N. River Drive  
Mankato, Minnesota 56001  
Phone 800-658-7010  
Fax 507-388-6348

ITEM NO.	PART NUMBER	DESCRIPTION	QTY	
2	140-37-1-CB	3/8" x 1" Carriage Bolt	4	Bolt Kit : 175-40220
3	140-37-NF	3/8" Brass Flange Nut	4	Bolt Kit : 175-40220
4	175-21090L	Bracket, 1/4" : Left	1	Bolt Kit : 175-40220
5	175-21090R	Bracket, 1/4" Right	1	Bolt Kit : 175-40220
6	140-31-2-LB	5/16" x 2" L Bolt	2	Bolt Kit : 175-40220

## Single Stage Connection

See photos on page 7.

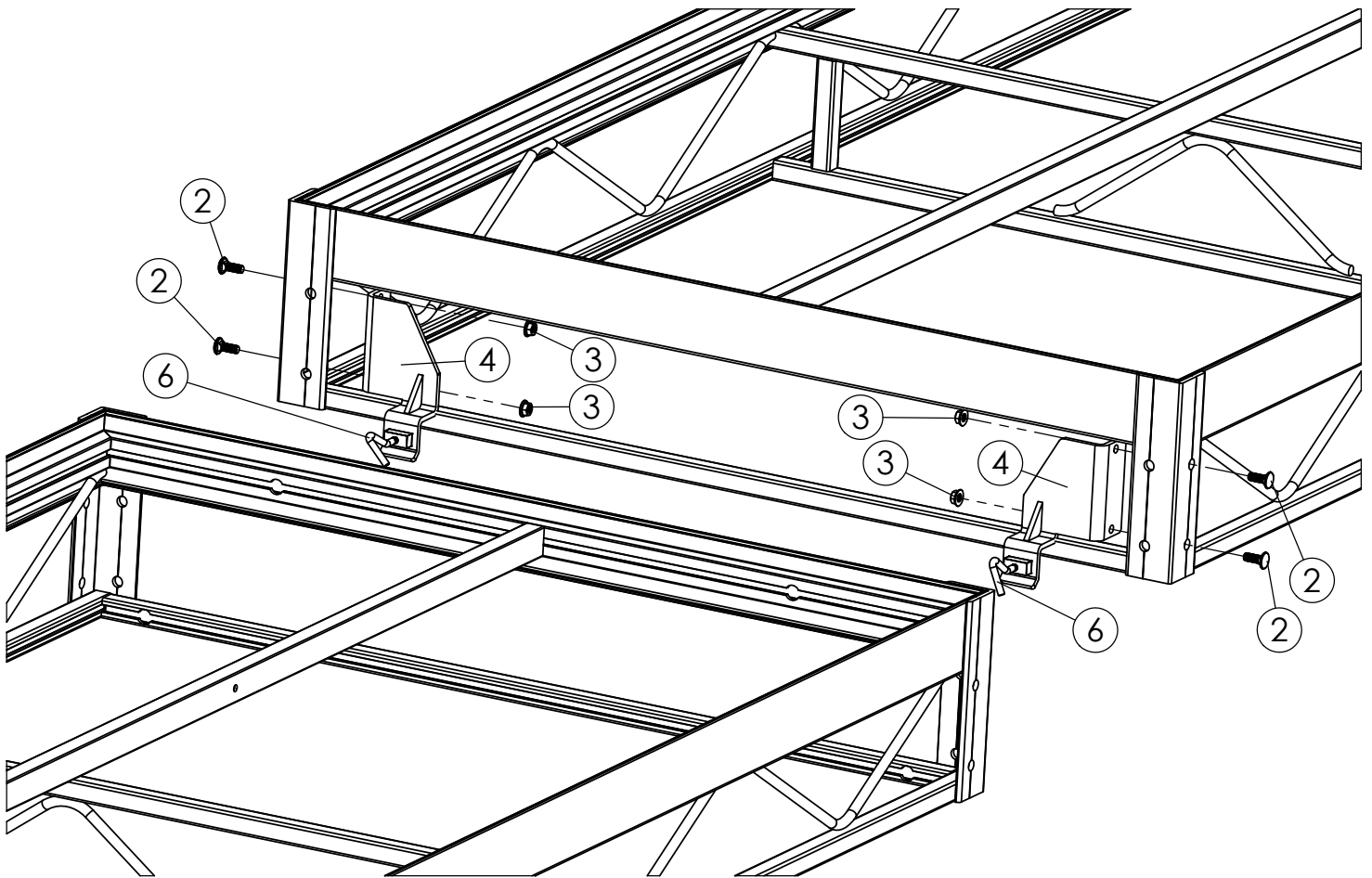

Part #:	175-40220	Description:	Single Stage Knob Connection
---------	-----------	--------------	------------------------------



1270 N. River Drive  
Mankato, Minnesota 56001  
Phone 800-658-7010  
Fax 507-388-6348

ITEM NO.	PART NUMBER	DESCRIPTION	QTY	
2	140-37-1-CB	3/8" x 1" Carriage Bolt	8	Bolt Kit : 175-40200
3	140-37-NF	3/8" Brass Flange Nut	8	Bolt Kit : 175-40200
4	175-21070	Channel, 3/8" : Formed	2	Bolt Kit : 175-40200
5	175-41010	Bearing, 1/2" x 5/8" : 1/2" Long	2	Bolt Kit : 175-40200
6	140-50-W	1/2" Flat Washer	2	Bolt Kit : 175-40200
7	140-50-2-B	1/2" x 2" Hex Head Bolt	2	Bolt Kit : 175-40200
8	140-50-NL	1/2" Brass Nylock Nut	2	Bolt Kit : 175-40200
9	175-21050L	Hook, Dual Stage : Left	1	Bolt Kit : 175-40200
10	175-21050R	Hook, Dual Stage : Right	1	Bolt Kit : 175-40200

## Dual Stage Connection See photos on page 7.

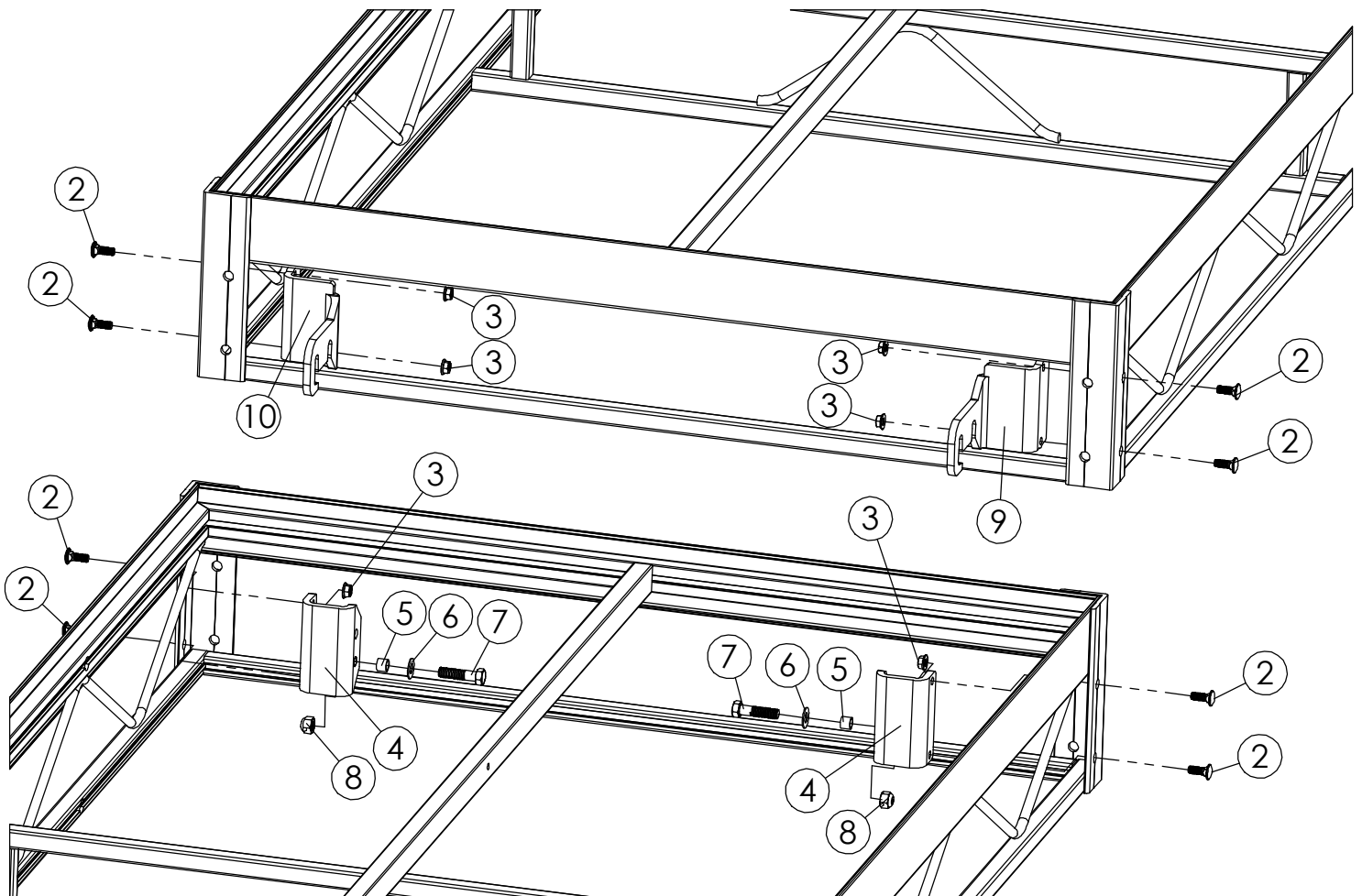

PAGE 6

Part #:	175-40200	Description:	Dual Stage Connection
---------	-----------	--------------	-----------------------



## Dock Connection Photos



Standard Bolt Kit is included with each frame. Use reinforcement plates for additional strength and stability.

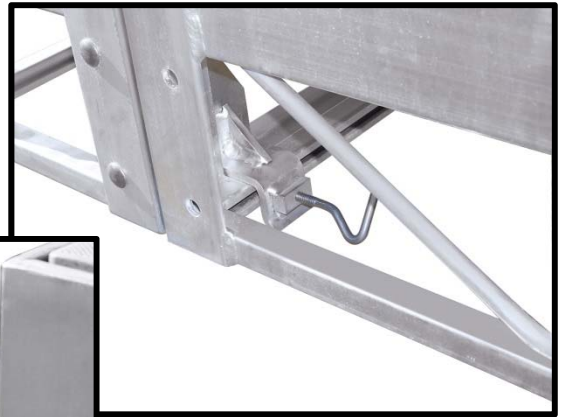

### 175-40220

The Single-Stage Hook System allows you to connect sections into any desired layout without any tools and provides ease of installation and removal of your dock one section at a time.

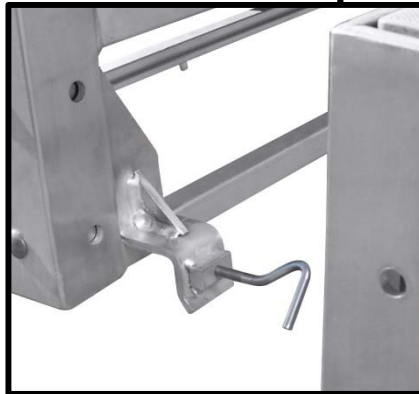

### Unlocked Position

### 175-40200

The Dual-Stage Connection System gives you the ability to maneuver over uneven shorelines and remove multiple sections at the same time in the unlocked position.

Place the connection in the locked position when dock sections are installed.

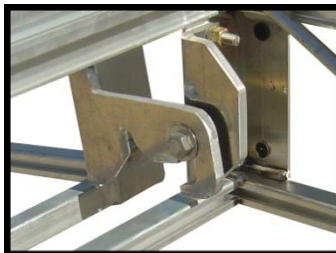

### Locked Position



### Dual-Stage Connection System



1270 N. River Drive  
Mankato, Minnesota 56001  
Phone 800-658-7010  
Fax 507-388-6348

-

ITEM NO.	PART NUMBER	DESCRIPTION	QTY	
1	175-90010	Frame, Roll-In : 4' x 16'	1	
2	175-90050	Frame, Roll-In : 4' x 8'	1	
3	175-24100	Flat, 1/4" x 2-1/2 : 10"	1	Bolt Kit : 175-40190
4	175-21030	Channel, 1/4" Formed	1	Bolt Kit : 175-40190
5	140-50-15-B	1/2" x 1-1/2" Hex Head Bolt	6	Bolt Kit : 175-40000
6	140-50-WL	1/2" SS Lock Washer	6	Bolt Kit : 175-40000
7	140-50-N	1/2" Brass Nut	6	Bolt Kit : 175-40000
8	175-20050	Plate, Reinforcement	1	

See photos on page 12.

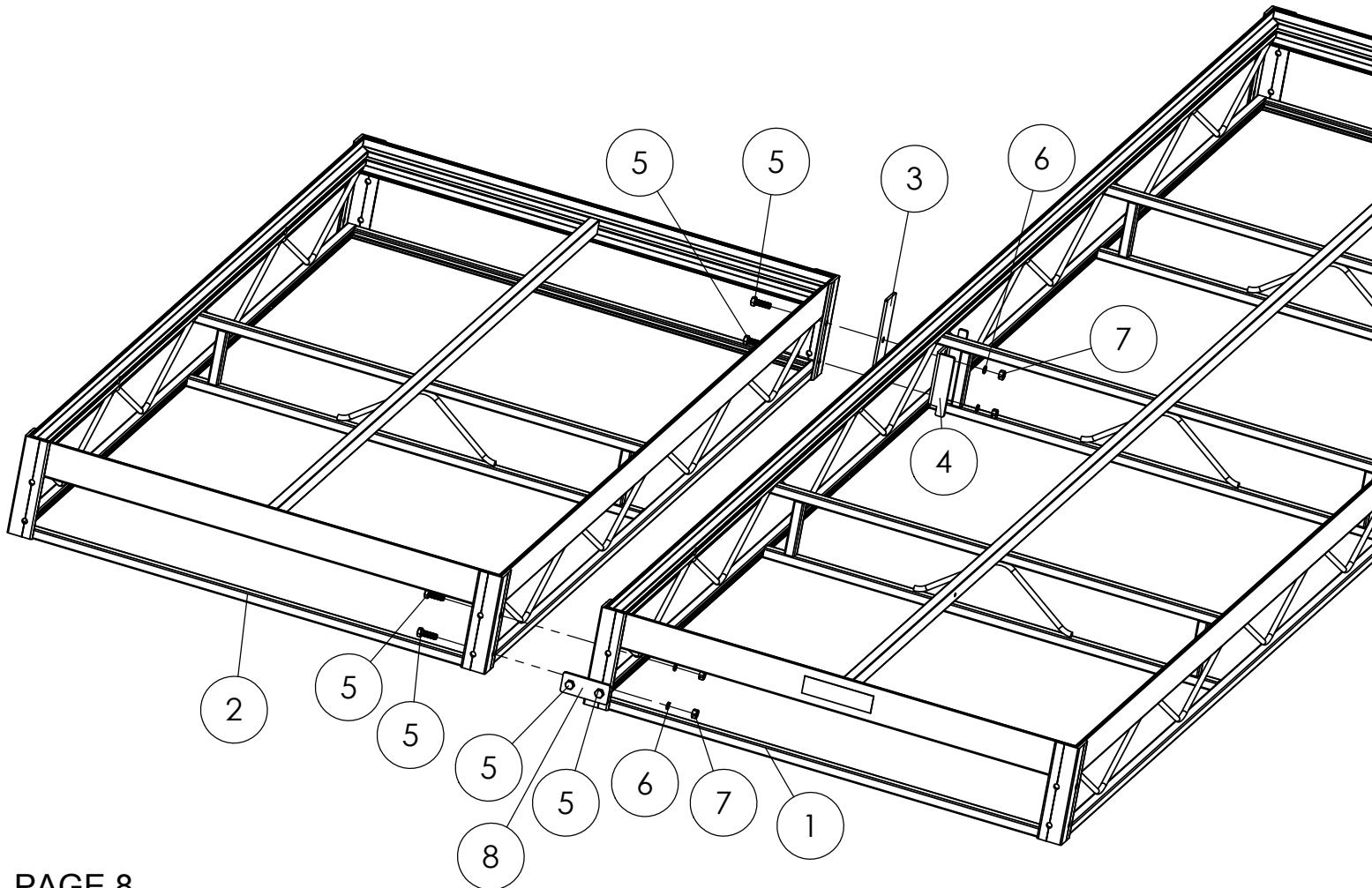

PAGE 8

Part #:	175-40190 Manual	Description:	Bolt Kit, L Section (1st)
---------	------------------	--------------	---------------------------





1270 N. River Drive  
Mankato, Minnesota 56001  
Phone 800-658-7010  
Fax 507-388-6348

ITEM NO.	PART NUMBER	DESCRIPTION	QTY	
2	175-20050	Plate, Reinforcement	2	Bolt Kit : 175-40000
3	140-50-15-B	1/2" x 1-1/2" Hex Head Bolt	8	Bolt Kit : 175-40000
4	140-50-WL	1/2" SS Lock Washer	8	Bolt Kit : 175-40000
5	140-50-N	1/2" Brass Nut	8	Bolt Kit : 175-40000

## Standard Connection

See photos on pages 12 and 13.

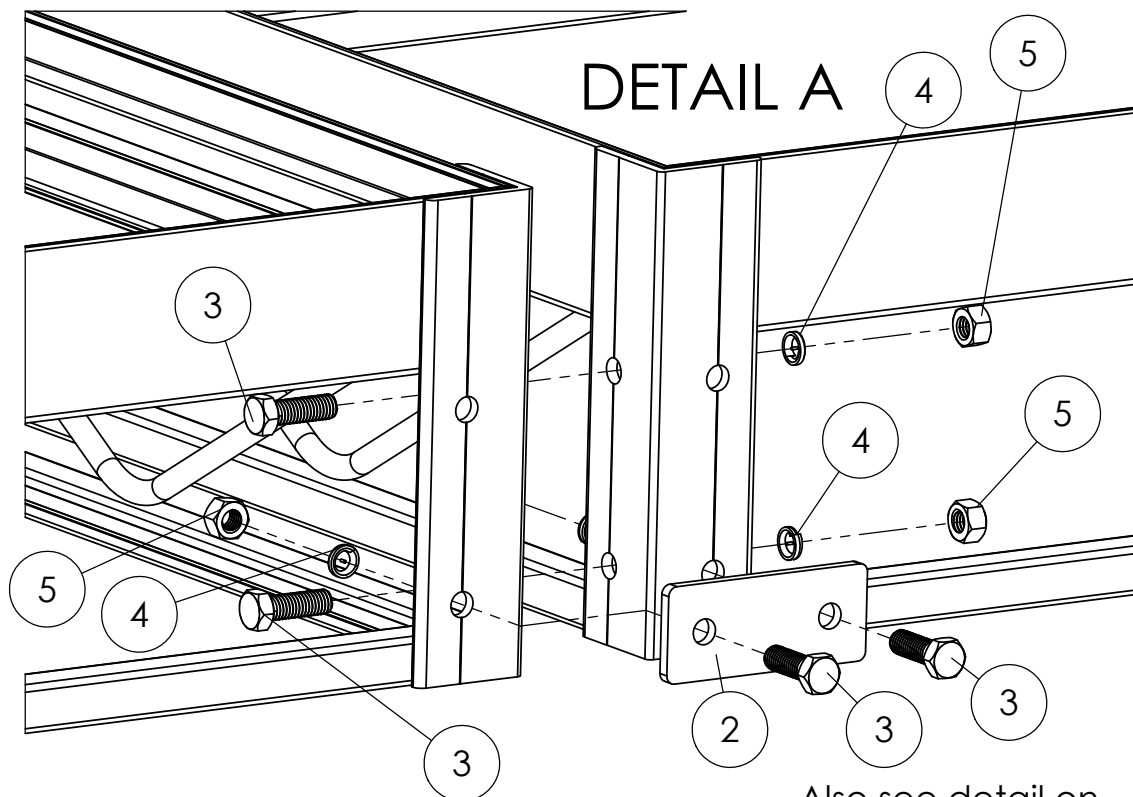

Also see detail on additional Bolt Kit : 175-40192 on page 13. This bolt kit is needed for bracing wheel kit with 2 L sections.

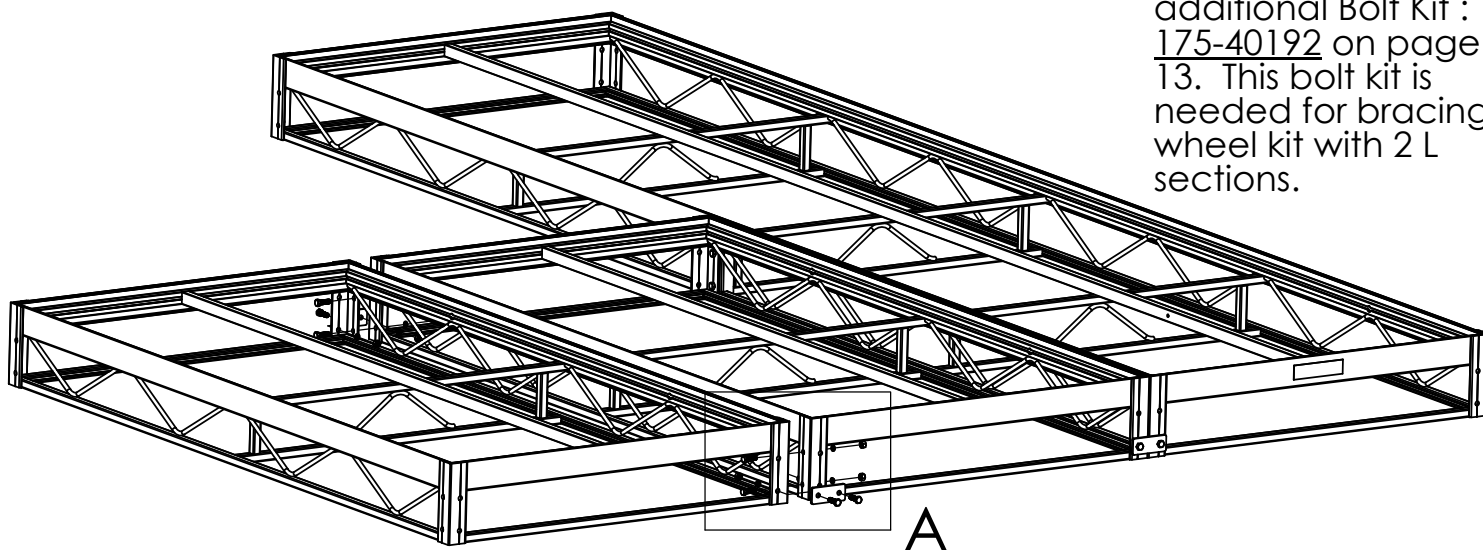

Part #:	175-40000-2L	Description:	Adding 2nd L Section
---------	--------------	--------------	----------------------



1270 N. River Drive  
Mankato, Minnesota 56001  
Phone 800-658-7010  
Fax 507-388-6348

ITEM NO.	PART NUMBER	DESCRIPTION	QTY	
2	175-30400	Tube, 1 x 2 : 144"	1	Bolt Kit : 175-40195
3	175-20070	Plate, U-Bolt : 1/4 x 1-1/2 x 3"	3	Bolt Kit : 175-40195
4	140-37-375-UB	3-3/4" U-Bolt	3	Bolt Kit : 175-40195
5	140-37-W	Washer, 3/8"	6	Bolt Kit : 175-40195
6	140-31-NF	3/8" Brass Nut	6	Bolt Kit : 175-40195

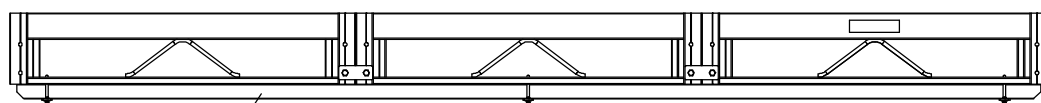

② END VIEW

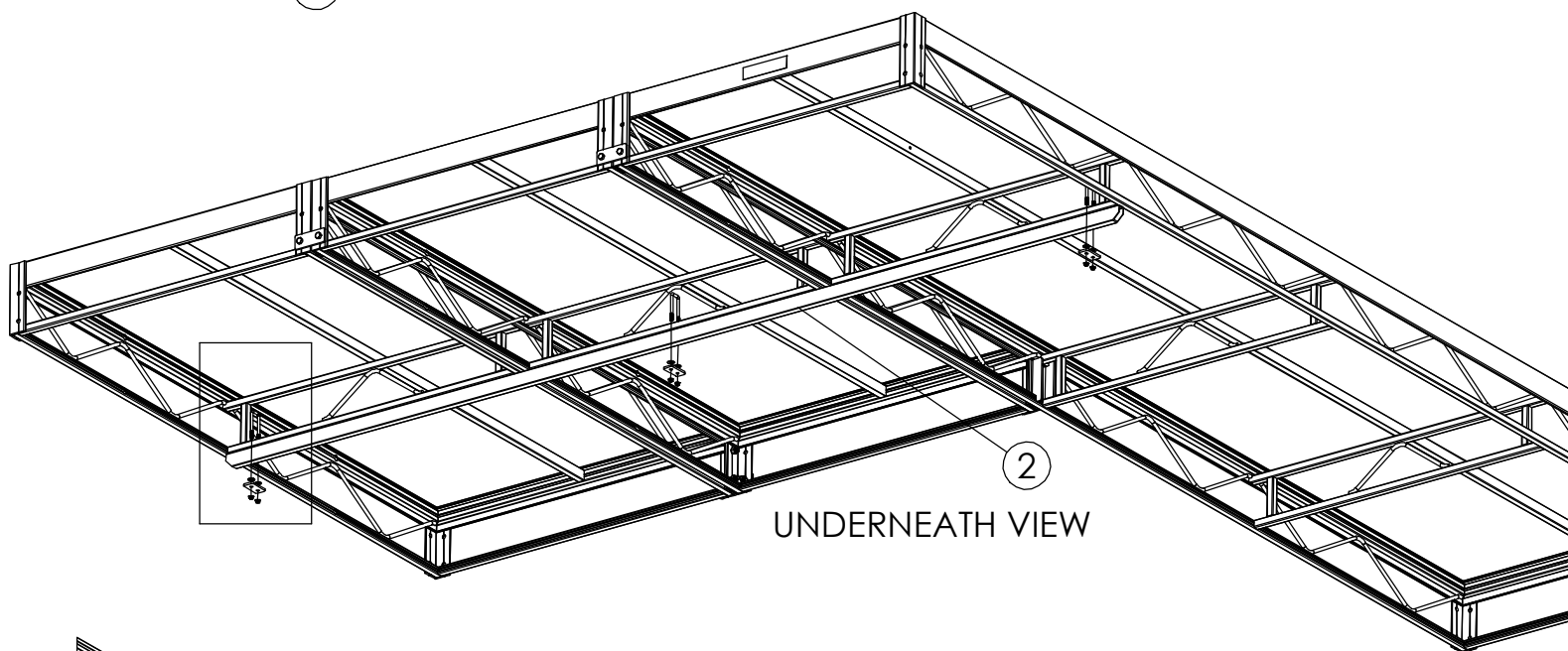

② UNDERNEATH VIEW

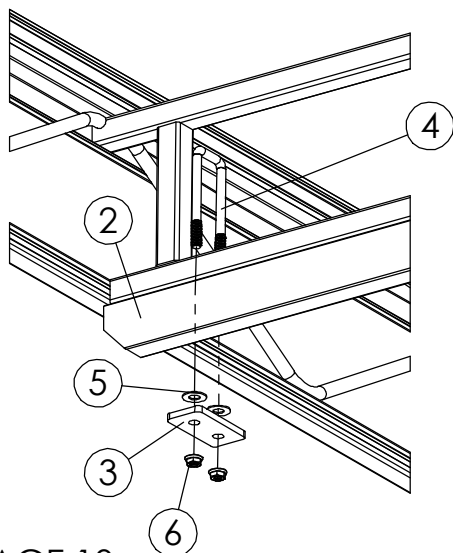

See photos on pages 12 and 13.



1270 N. River Drive  
Mankato, Minnesota 56001  
Phone 800-658-7010  
Fax 507-388-6348

ITEM NO.	PART NUMBER	DESCRIPTION	QTY	
2	176-81000	Frame, Corner	1	
3	176-27135	Bracket, Connection : 2-1/4" Inside	3	Bolt Kit : 176-40100
4	140-31-1-CB	5/16" x 1" Carriage Bolt	8	Bolt Kit : 176-40100
5	140-31-NF	5/16" Brass Flange Nut	8	Bolt Kit : 176-40100

Two Carriage Bolts and Brass Flange Nuts secure each Bracket to the track.

Three brackets create a plane for the corner frame to be installed.

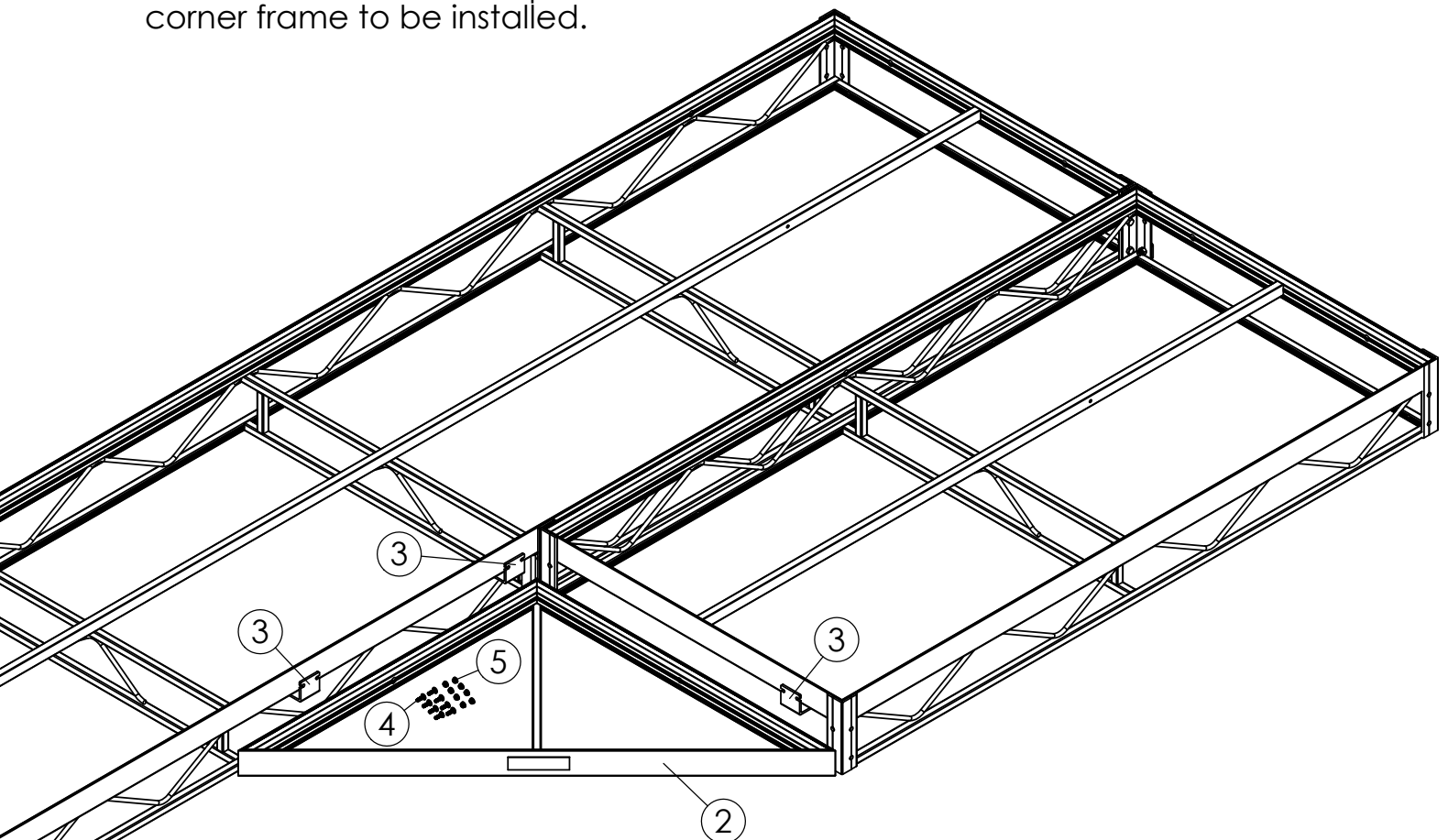

The corner frame can rest on the brackets.

Installing the corner frame permanently - Two extra Carriage Bolts and Brass Flange Nuts are provided to be used on the corner frame track.

Part #:	176-40100	Description:	Connecting Corner Section Frame
---------	-----------	--------------	---------------------------------

## Platform and Corner Section Photos



**L Dock Wheel Kit**



**12' Tube for Platform Support : Bolt Kit (175-40195)**



**Corner Section : Bolt Kit(176-40100)**



**Straight Dock  
Wheel Kit**



**Bolt Kit (175-40190) First L Section**  
This bolt kit includes the needed  
channel bracket and flat spacer for  
attaching the first L section



## Wheel Kit Photos



**Straight Dock  
Wheel Kit**



**Optional Adjustment Crank (175-42000)**

1-1/8" socket with handle to easily adjust height of the dock.



**L Dock Wheel Kit  
with additional Bolt  
Kit (175-40192) for  
bracing wheel kit.**



**Bolt Kit (175-40192)**

This additional bolt kit is needed for bracing wheel kit with L sections.



**L Dock Wheel Kit**

Wheels may be installed to the inside of the dock to eliminate interference with a boat lift.

# Straight Dock Wheel Kits



Extra Shallow Bolt kit is 175-40120

ITEM NO.	PART #	DESCRIPTION	175-95210 Extra Shallow 18"-26" Water QTY / PAIR	175-95220 Shallow 24"-42" Water QTY / PAIR	
2	175-21025	Bracket, Brace : 3/16"		1	Bolt Kit : 175-40105
3	175-23100	Bracket, Brace : 1-1/4"		2	Bolt Kit : 175-40105
4	175-23200	Bracket, Leg Brace : 1-1/4"		2	Bolt Kit : 175-40105
5	175-30250	Tube, 1" x 1" x 1/8" : 26"		4	
6	175-53205	Outer Leg, 18" w/ Screw	2		
6	175-53210	Outer Leg, 26" w/ Screw		2	
7	175-50600	Spindle, Roll-In Wheel	2	2	Bolt Kit : 175-40105
8	140-31-1-CB	5/16" x 1" Carriage Bolt	8	10	Bolt Kit : 175-40105
9	140-31-NF	5/16" Brass Flange Nut	10	25	Bolt Kit : 175-40105
10	140-31-2-B	5/16" x 2" Hex Head Bolt		7	Bolt Kit : 175-40105
11	140-31-75-B	5/16" x 3/4" Hex Head Bolt		4	Bolt Kit : 175-40105
12	140-31-15-B	5/16" x 1-1/2" Hex Head Bolt		2	Bolt Kit : 175-40105
13	PEV2000	Plug : 2"	2	2	Bolt Kit : 175-40105
14	140-31-3-B	5/16" x 3" Hex Head Bolt	2	2	Bolt Kit : 175-40105
15	140-18-3-CP	3/16" x 3" Cotter Pin	2	2	Bolt Kit : 175-40105
16	140-175-W	Washer, Wheel Kit	4	4	Bolt Kit : 175-40105
17	175-48000	Rotomolded Wheel	2	2	

ITEM NO.	PART #	DESCRIPTION	175-95240 Medium 36"-60" Water QTY / PAIR	175-95260 Deep 46"-74" Water QTY / PAIR	
2	175-21025	Bracket, Brace : 3/16"	1	1	Bolt Kit : 175-40105
3	175-23100	Bracket, Brace : 1-1/4"	2	2	Bolt Kit : 175-40105
4	175-23200	Bracket, Leg Brace : 1-1/4"	2	2	Bolt Kit : 175-40105
5	175-30230	Tube, 1" x 1" x 1/8" : 30"	4	4	
6	175-53215	Outer Leg, 38" w/ Screw	2		
6	175-53220	Outer Leg, 48" w/ Screw		2	
7	175-50600	Spindle, Roll-In Wheel	2	2	Bolt Kit : 175-40105
8	140-31-1-CB	5/16" x 1" Carriage Bolt	10	10	Bolt Kit : 175-40105
9	140-31-NF	5/16" Brass Flange Nut	25	25	Bolt Kit : 175-40105
10	140-31-2-B	5/16" x 2" Hex Head Bolt	7	7	Bolt Kit : 175-40105
11	140-31-75-B	5/16" x 3/4" Hex Head Bolt	4	4	Bolt Kit : 175-40105
12	140-31-15-B	5/16" x 1-1/2" Hex Head Bolt	2	2	Bolt Kit : 175-40105
13	PEV2000	Plug : 2"	2	2	Bolt Kit : 175-40105
14	140-31-3-B	5/16" x 3" Hex Head Bolt	2	2	Bolt Kit : 175-40105
15	140-18-3-CP	3/16" x 3" Cotter Pin	2	2	Bolt Kit : 175-40105
16	140-175-W	Washer, Wheel Kit	4	4	Bolt Kit : 175-40105
17	175-48000	Rotomolded Wheel	2	2	



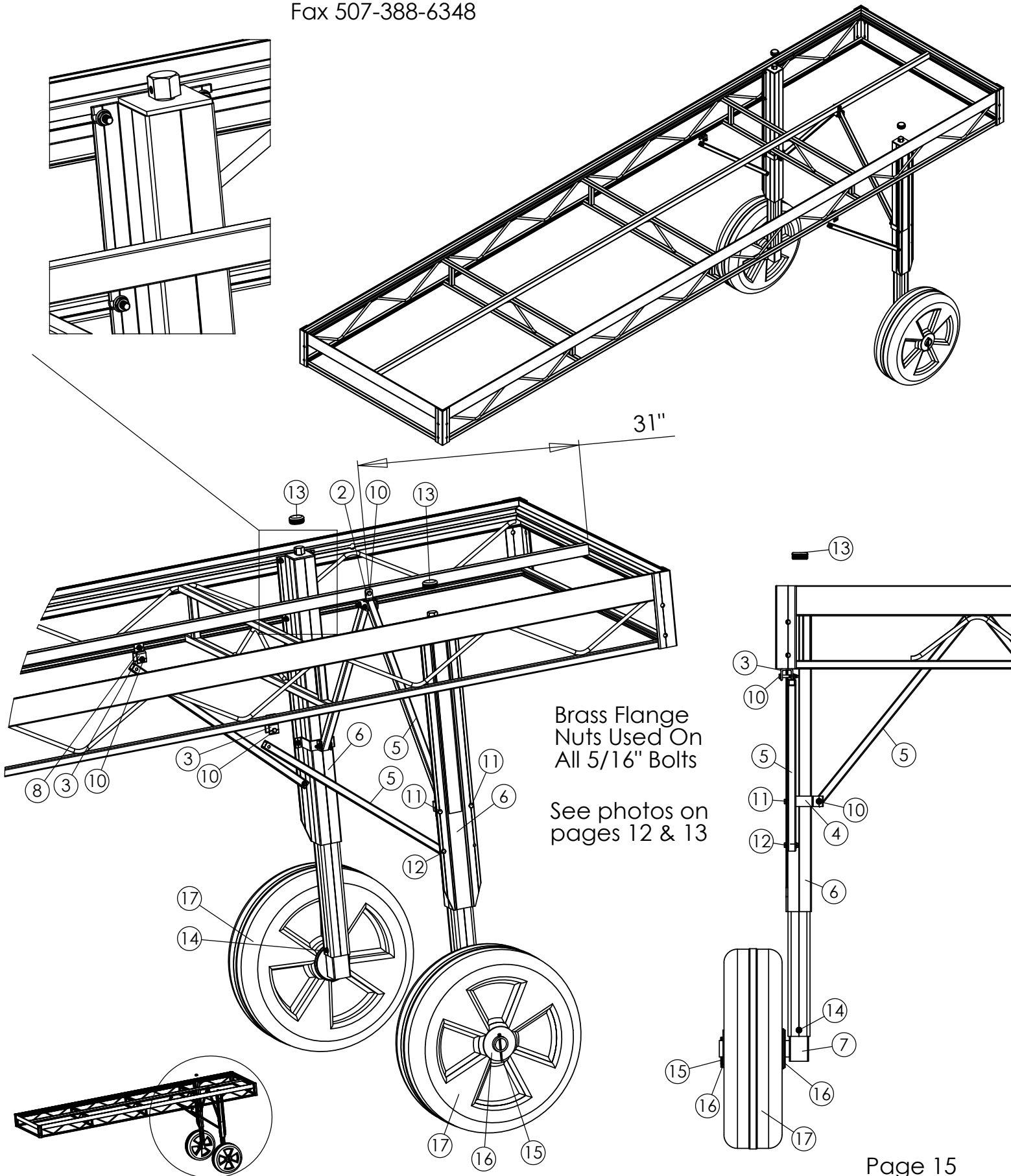

# L Dock Wheel Kits

ITEM NO.	PART #	DESCRIPTION	175-95120	175-95140	175-95160	
			Shallow	Medium	Deep	
			24"-42" Water	36"-60" Water	46"-74" Water	
			QTY / PAIR	QTY / PAIR	QTY / PAIR	
2	175-53210	Outer Leg, 26" w/ Screw	2			
2	175-53215	Outer Leg, 38" w/ Screw		2		
2	175-53220	Outer Leg, 48" w/ Screw			2	
3	175-23100	Bracket, Brace : 1-1/4"	4	4	4	Bolt Kit : 175-40110
4	175-23200	Bracket, Leg Brace : 1-1/4"	2	2	2	Bolt Kit : 175-40110
5	175-30250	Tube, 1" x 1" x 1/8" : 26"	4			
5	175-30230	Tube, 1" x 1" x 1/8" : 30"		4	4	
6	175-82000	Bracket, Brace : L	1	1	1	Bolt Kit : 175-40110
7	175-30330	Tube, 1" x 1" x 1/8" : 44-1/2"	2			
7	175-30340	Tube, 1" x 1" x 1/8" : 46-1/4"		2	2	
8	175-50600	Spindle, Roll-In Wheel	2	2	2	Bolt Kit : 175-40110
9	175-48000	Rotomolded Wheel	2	2	2	
10	140-175-W	Washer, Wheel Kit	4	4	4	Bolt Kit : 175-40110
11	140-18-3-CP	3/16" x 3" Cotter Pin	2	2	2	Bolt Kit : 175-40110
12	140-31-3-B	5/16" x 3" Hex Head Bolt	2	2	2	Bolt Kit : 175-40110
13	140-31-2-B	5/16" x 2" Hex Head Bolt	8	8	8	Bolt Kit : 175-40110
14	140-31-NF	5/16" Brass Flange Nut	32	32	32	Bolt Kit : 175-40110
15	140-31-35-B	5/16" x 3-1/2" Hex Head Bolt	2	2	2	Bolt Kit : 175-40110
16	140-31-1-CB	5/16" x 1" Carriage Bolt	12	12	12	Bolt Kit : 175-40110
17	140-31-75-B	5/16" x 3/4" Hex Head Bolt	4	4	4	Bolt Kit : 175-40110
18	140-31-15-B	5/16" x 1-1/2" Hex Head Bolt	4	4	4	Bolt Kit : 175-40110
19	PEV2000	Plug : 2"	2	2	2	Bolt Kit : 175-40110

## Single Legs

ITEM NO.	PART #	DESCRIPTION	175-95120S	175-95140S	175-95160S	
			Shallow	Medium	Deep	
			24"-42" Water	36"-60" Water	46"-74" Water	
			QTY / SINGLE	QTY / SINGLE	QTY / SINGLE	
2	175-53210	Outer Leg, 26" w/ Screw	1			
2	175-53215	Outer Leg, 38" w/ Screw		1		
2	175-53220	Outer Leg, 48" w/ Screw			1	
3	175-23100	Bracket, Brace : 1-1/4"	2	2	2	Bolt Kit : 175-40110S
4	175-23200	Bracket, Leg Brace : 1-1/4"	1	1	1	Bolt Kit : 175-40110S
5	175-30250	Tube, 1" x 1" x 1/8" : 26"	2			
5	175-30230	Tube, 1" x 1" x 1/8" : 30"		2	2	
6	175-82000	Bracket, Brace : L	1	1	1	Bolt Kit : 175-40110S
7	175-30330	Tube, 1" x 1" x 1/8" : 44-1/2"	1			
7	175-30340	Tube, 1" x 1" x 1/8" : 46-1/4"		1	1	
8	175-50600	Spindle, Roll-In Wheel	1	1	1	Bolt Kit : 175-40110S
9	175-48000	Rotomolded Wheel	1	1	1	
10	140-175-W	Washer, Wheel Kit	2	2	2	Bolt Kit : 175-40110S
11	140-18-3-CP	3/16" x 3" Cotter Pin	1	1	1	Bolt Kit : 175-40110S
12	140-31-3-B	5/16" x 3" Hex Head Bolt	1	1	1	Bolt Kit : 175-40110S
13	140-31-2-B	5/16" x 2" Hex Head Bolt	4	4	4	Bolt Kit : 175-40110S
14	140-31-NF	5/16" Brass Flange Nut	16	16	16	Bolt Kit : 175-40110S
15	140-31-35-B	5/16" x 3-1/2" Hex Head Bolt	1	1	1	Bolt Kit : 175-40110S
16	140-31-1-CB	5/16" x 1" Carriage Bolt	6	6	6	Bolt Kit : 175-40110S
17	140-31-75-B	5/16" x 3/4" Hex Head Bolt	2	2	2	Bolt Kit : 175-40110S
18	140-31-15-B	5/16" x 1-1/2" Hex Head Bolt	2	2	2	Bolt Kit : 175-40110S
19	PEV2000	Plug : 2"	1	1	1	Bolt Kit : 175-40110S



1270 N. River Drive  
Mankato, Minnesota 56001  
Phone 800-658-7010  
Fax 507-388-6348

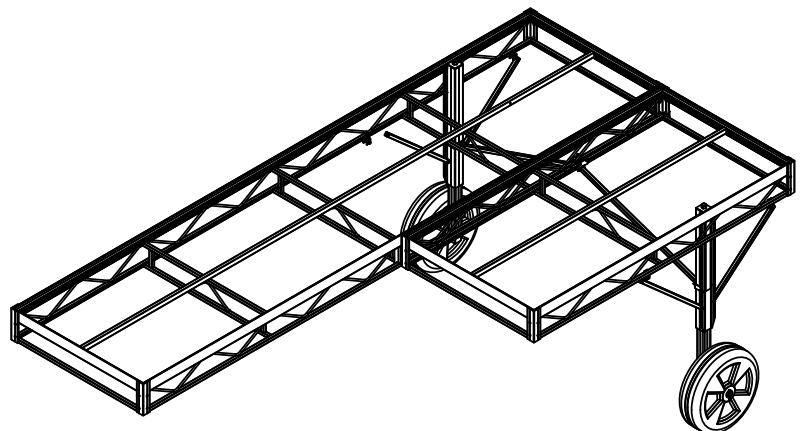
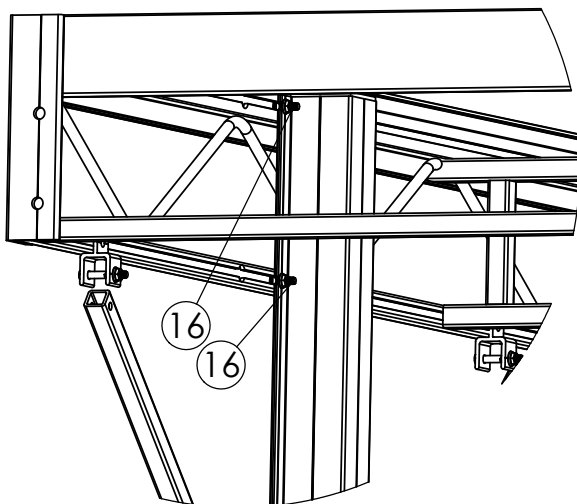
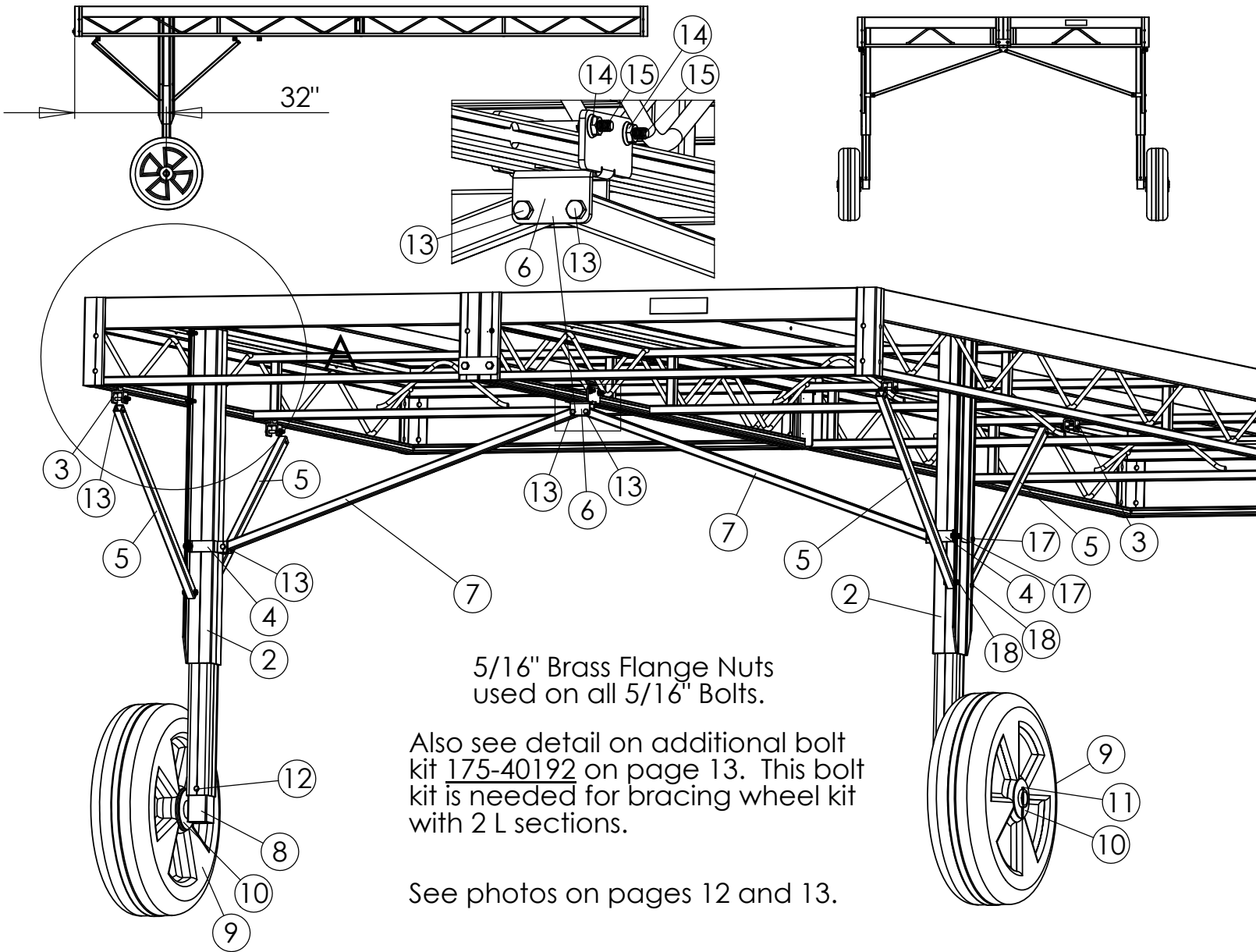



1270 N. River Drive  
Mankato, Minnesota 56001  
Phone 800-658-7010  
Fax 507-388-6348

ITEM NO.	PART NUMBER	DESCRIPTION	QTY	
1	175-90010	Frame, Roll-In : 4' x 16'	1	
2	175-52100	Outer Leg : 14" with Set Screw	2	Bolt Kit : 175-40170
3	175-32224	Tube, 2" x 2" : 24" Drop Leg	2	Post Kit : 175-96010
3	175-32248	Tube, 2" x 2" : 48" Drop Leg	2	Post Kit : 175-96020
3	172-32272	Tube, 2" x 2" : 72" Drop Leg	2	Post Kit : 175-96030
3	175-32296	Tube, 2" x 2" : 96" Drop Leg	2	Post Kit : 175-96040
4	175-81050	Footpad, Roll-In : Welded	2	Bolt Kit : 175-40170
5	140-31-25-B	5/16" x 2-1/2" Hex Head Bolt	2	Bolt Kit : 175-40170
6	140-31-NF	5/16" Brass Flange Nut	10	Bolt Kit : 175-40170
7	175-21010	Plate, Inside : 4.625"	2	Bolt Kit : 175-40170
8	140-31-2-CB	5/16" x 2" Carriage Bolt	8	Bolt Kit : 175-40170
9	CEV2020	Cap, End 2" x 2"	2	Bolt Kit : 175-40170

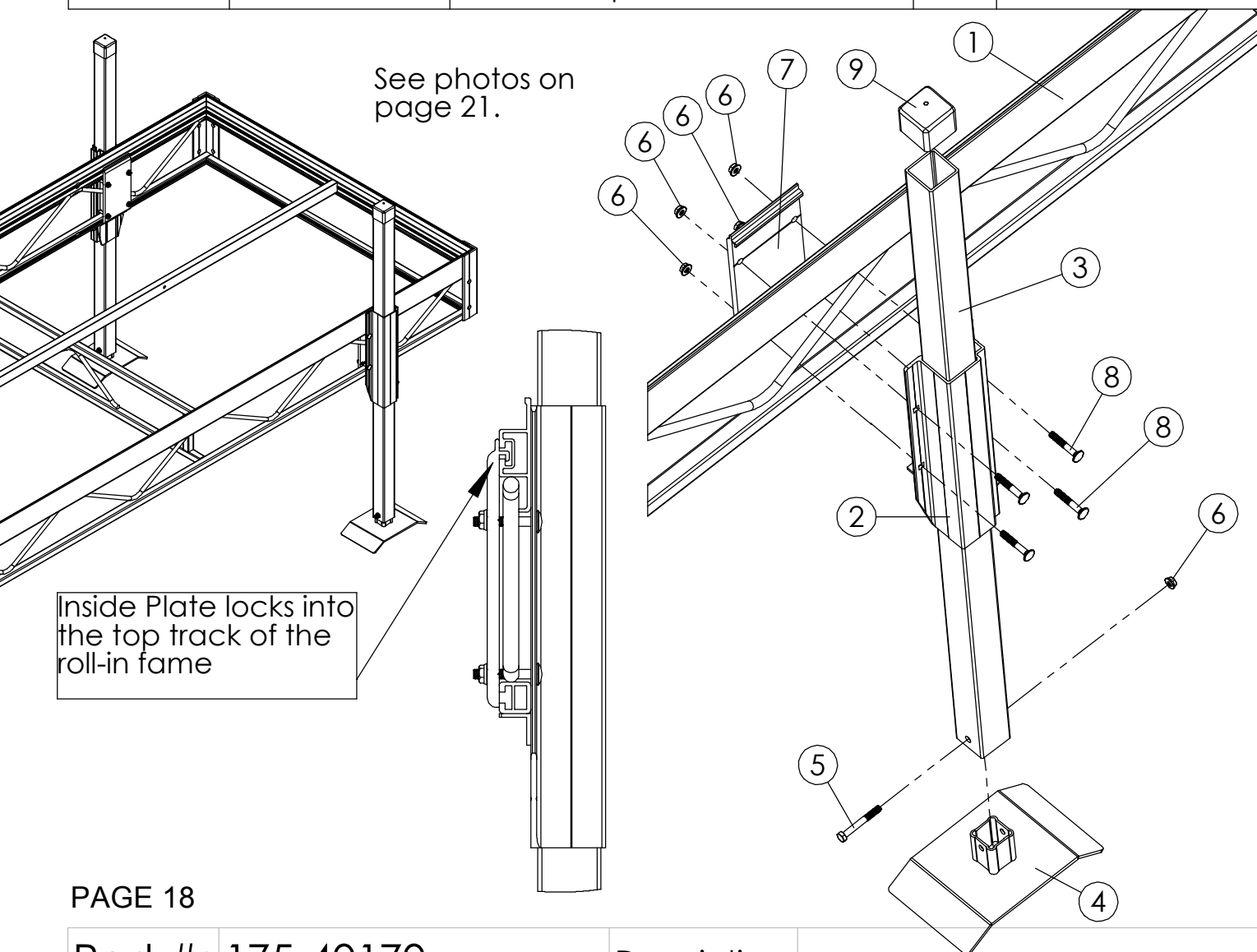

Part #:	175-40170	Description:	Bolt Kit, Set Screw Drop Legs (Pair)
---------	-----------	--------------	--------------------------------------



1270 N. River Drive  
Mankato, Minnesota 56001  
Phone 800-658-7010  
Fax 507-388-6348

ITEM NO.	PART NUMBER	DESCRIPTION	QTY	
1	175-90010	Frame, Roll-In : 4' x 16'	1	
2	175-52100	Outer Leg : 14" with Set Screw	1	Bolt Kit : 175-40170
3	175-32224	Tube, 2" x 2" : 24" Drop Leg	2	Post Kit : 175-96010
3	175-32248	Tube, 2" x 2" : 48" Drop Leg	1	Post Kit : 175-96020
3	172-32272	Tube, 2" x 2" : 72" Drop Leg	2	Post Kit : 175-96030
3	175-32296	Tube, 2" x 2" : 96" Drop Leg	2	Post Kit : 175-96040
4	175-81050	Footpad, Roll-In : Welded	1	Bolt Kit : 175-40170
5	140-31-25-B	5/16" x 2-1/2" Hex Head Bolt	1	Bolt Kit : 175-40170
6	140-31-NF	5/16" Brass Flange Nut	5	Bolt Kit : 175-40170
7	175-21010	Plate, Inside : 4.625"	1	Bolt Kit : 175-40170
8	140-31-2-CB	5/16" x 2" Carriage Bolt	4	Bolt Kit : 175-40170
9	CEV2020	Cap, End 2" x 2"	1	Bolt Kit : 175-40170

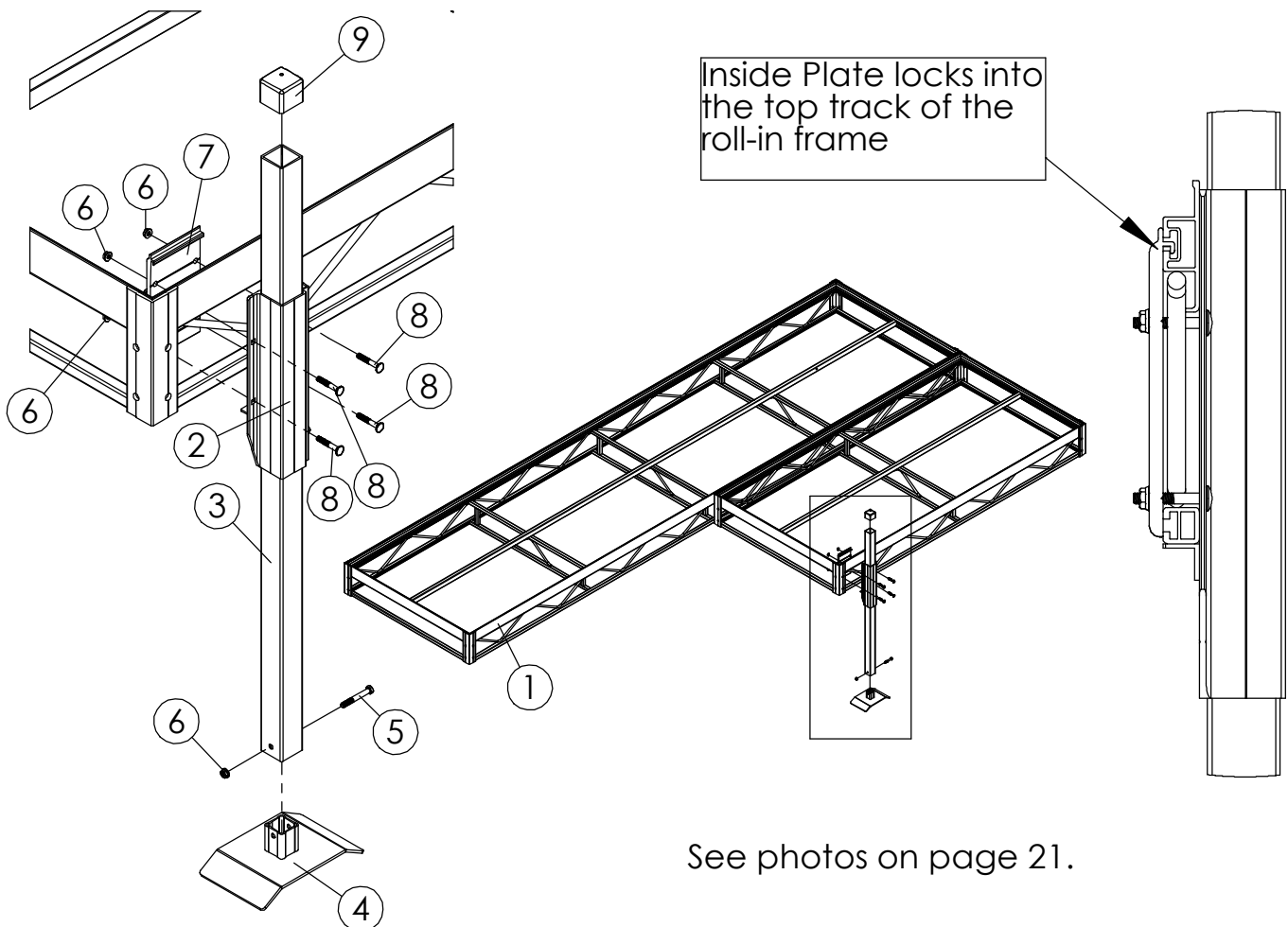



1270 N. River Drive  
Mankato, Minnesota 56001  
Phone 800-658-7010  
Fax 507-388-6348

ITEM NO.	PART NUMBER	DESCRIPTION	QTY.	
1	140-31-NF	5/16" Brass Flange Nut	2	Bolt Kit : 175-40125
8	175-48000	Wheel, Roll-In	2	Rotomolded Wheel
9	175-50600	Spindle, Roll-In Wheel	2	Bolt Kit : 175-40125
10	140-18-3-CP	3/16" x 3" SS Cotter Pin	2	Bolt Kit : 175-40125
11	140-175-W	Washer, Wheel Kit	4	Bolt Kit : 175-40125
12	140-31-3-B	5/16" x 3" Hex Head Bolt	2	Bolt Kit : 175-40125

See photos on page 21.

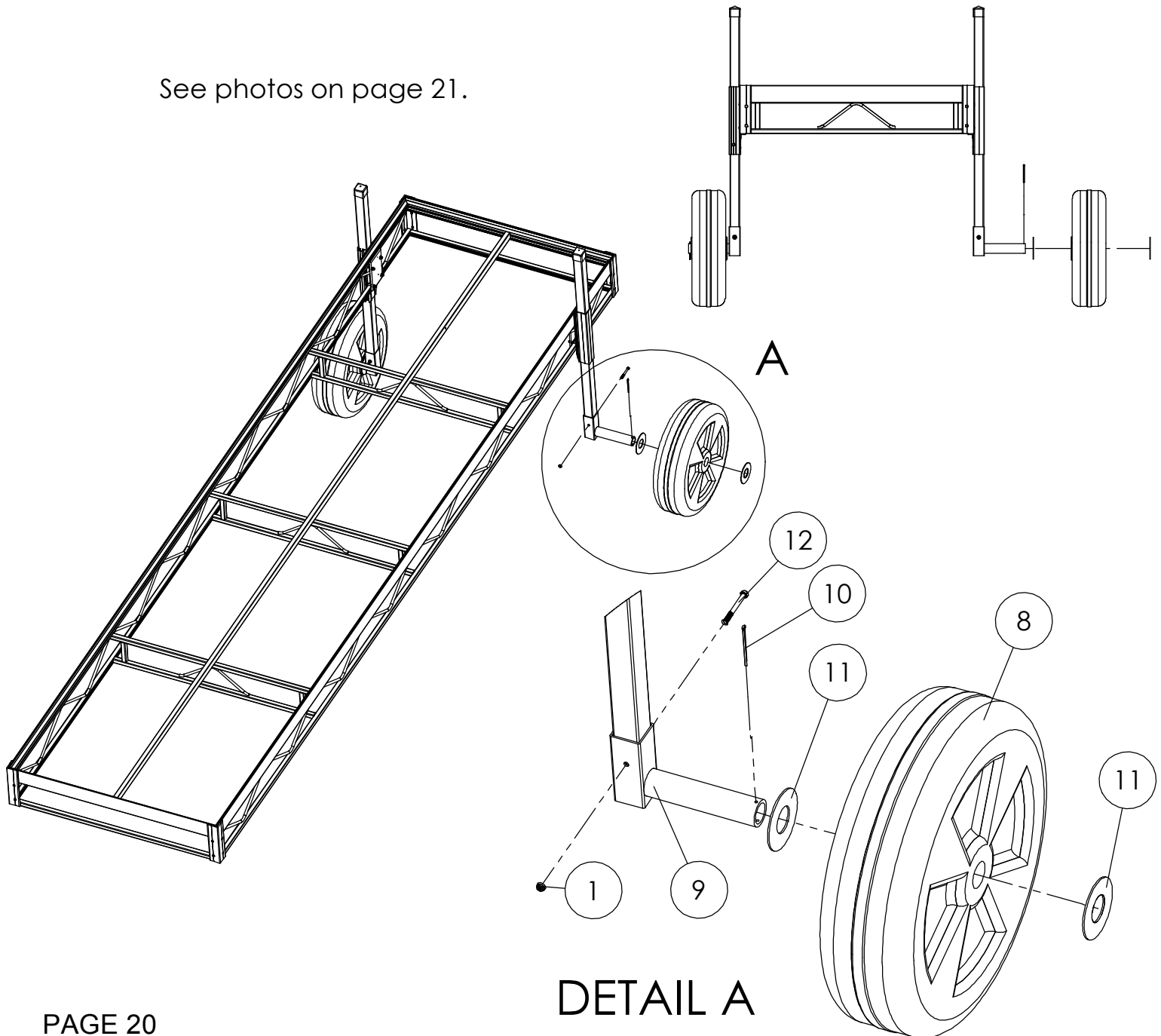

Part #:	175-96100	Description:	Wheel Kit for Posts (Pair)
---------	-----------	--------------	----------------------------





**Single Post Leg** for additional strength and stability on the platform.

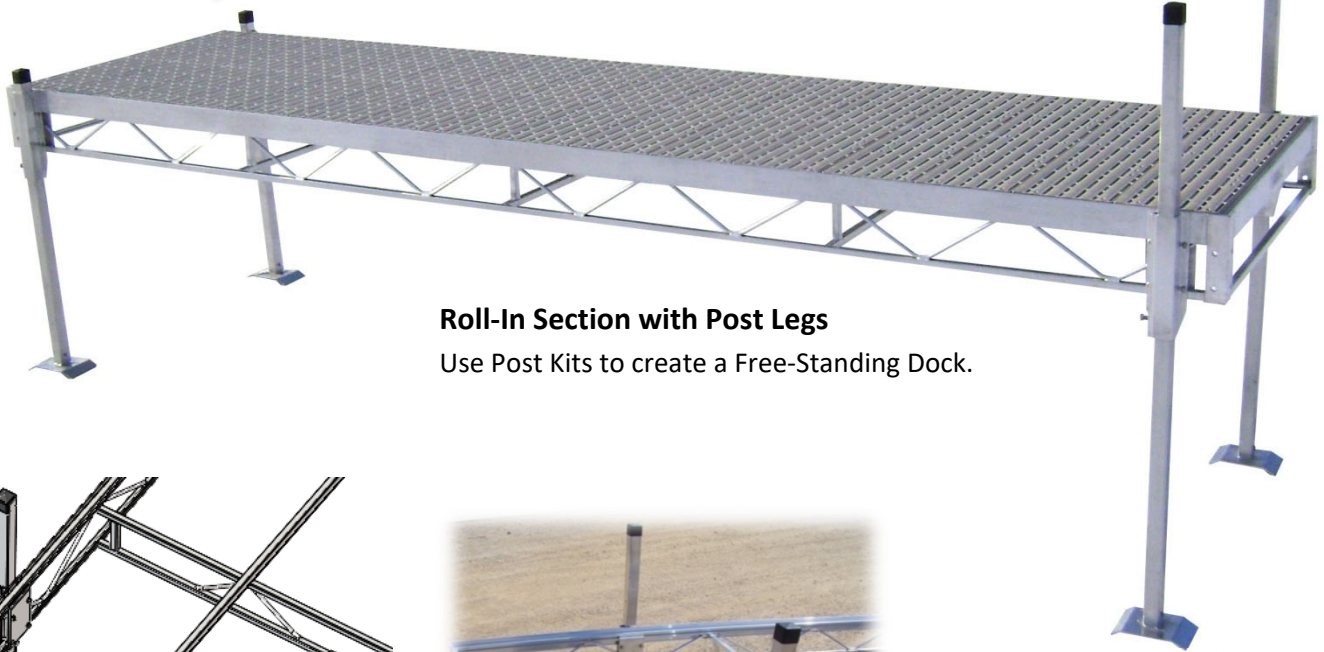

**Roll-In Section with Post Legs**

Use Post Kits to create a Free-Standing Dock.

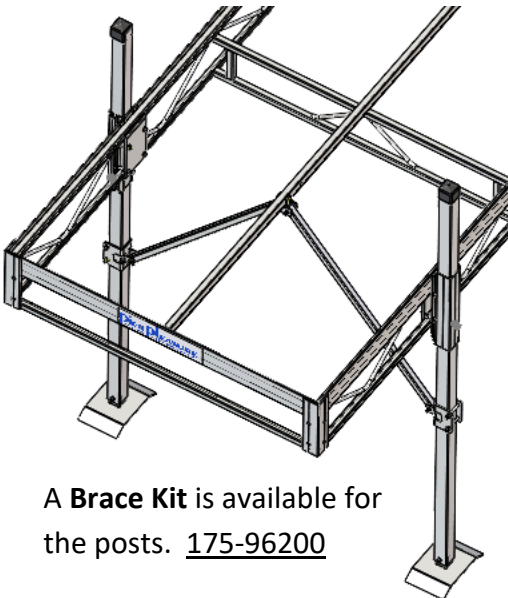

A **Brace Kit** is available for the posts. [175-96200](https://www.porta.com/175-96200)



**Wheel Kit for Post**

Wheels can be added to any to any Set Screw Post Legs. The combination of a 2' Post Kit [175-96010](https://www.porta.com/175-96010) or 4' Post Kit [175-96020](https://www.porta.com/175-96020) and Wheel Kit [175-96100](https://www.porta.com/175-96100) will make an adjustable shore end wheel kit.





1270 N. River Drive  
Mankato, Minnesota 56001  
Phone 800-658-7010  
Fax 507-388-6348

ITEM NO.	PART NUMBER	DESCRIPTION	QTY.
1	175-90090A	Frame, 4' x 4' Ramp	1
2	175-90050	Frame, Roll-In : 4' x 8'	1
3	484-10010	Panel, Titan	1
4	170-43-HM	Hinge, Male : 43" : Roll-In Ramp	1
5	140-12-TEKSCRW	Screw, TEK	5

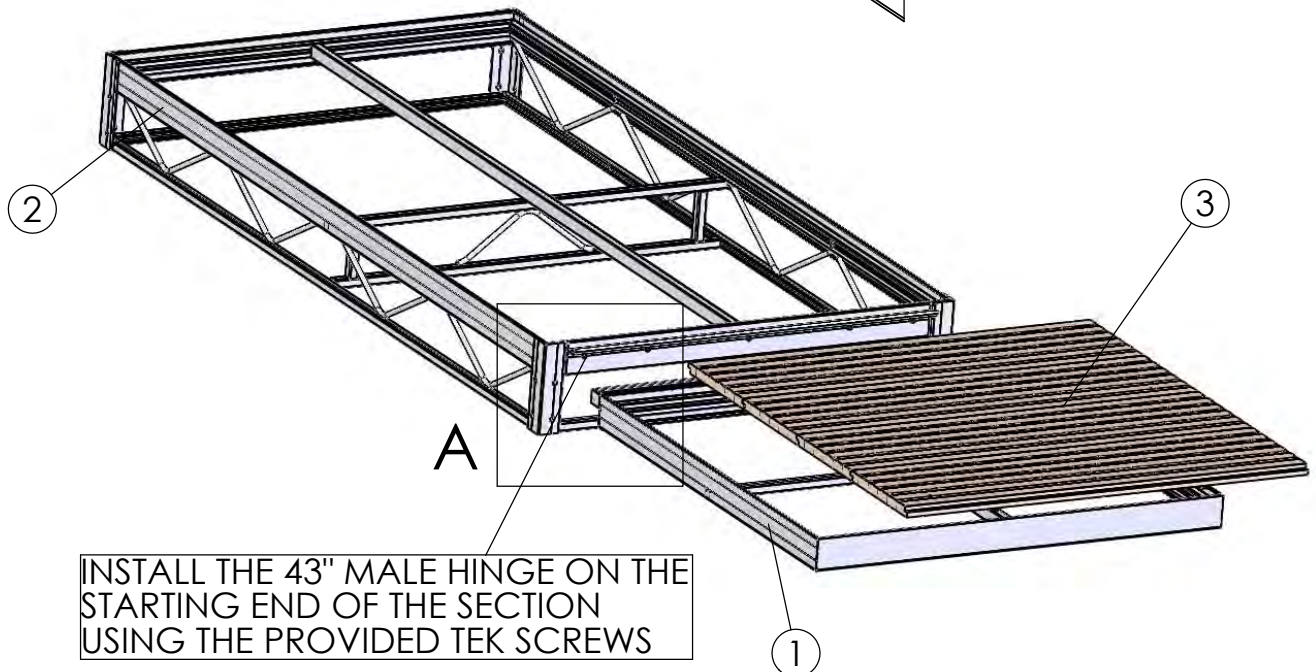
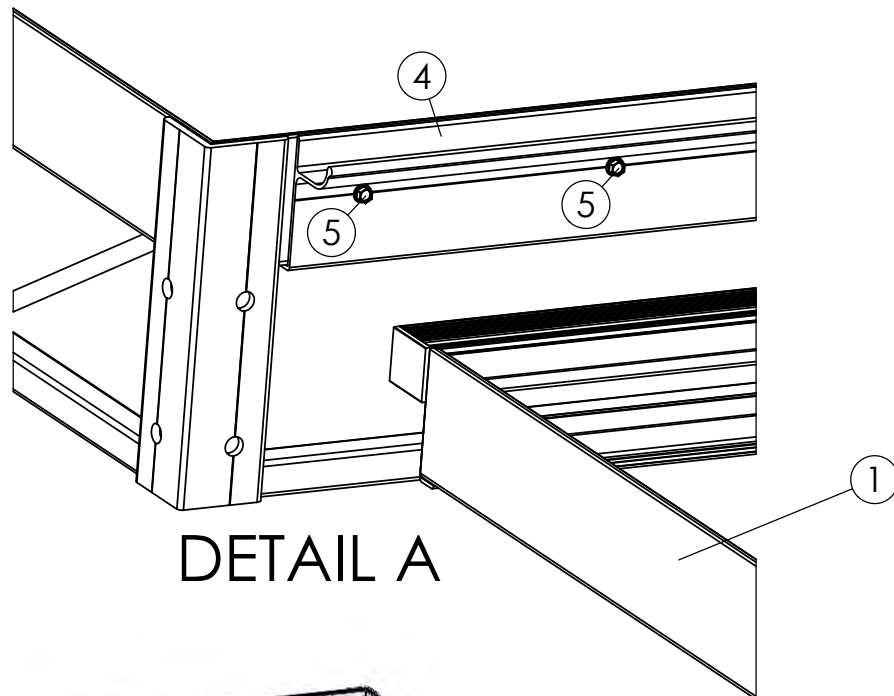

Part #:	175-91090	Description:	Ramp, 4' x 4' : Titan Panels
---------	-----------	--------------	------------------------------



1270 N. River Drive  
Mankato, Minnesota 56001  
Phone 800-658-7010  
Fax 507-388-6348

ITEM NO.	PART NUMBER	DESCRIPTION	QTY.
1	175-90050	Frame, Roll-In : 4' x 8'	1
2	484-10010	Panel, Titan	2
3	170-43-HM	Hinge, Male : 43" : Roll-In Ramp	1
4	140-12-TEKSCRW	Screw, TEK	5
5	175-90095	Frame, Ramp : 4' x 8'	1

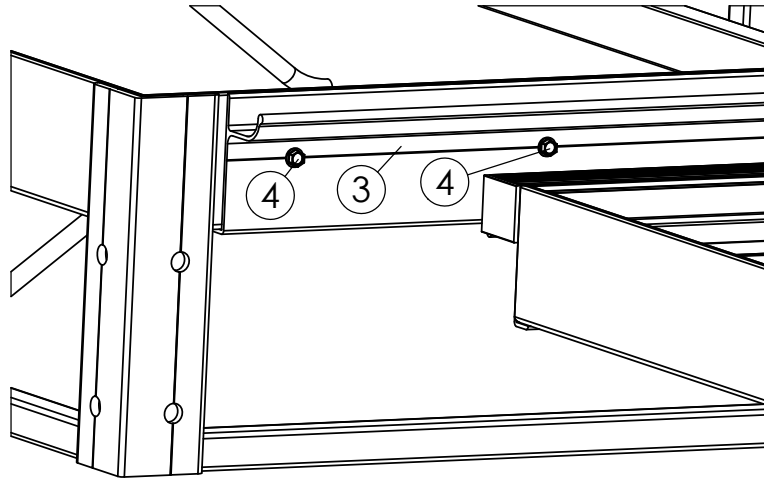

DETAIL A

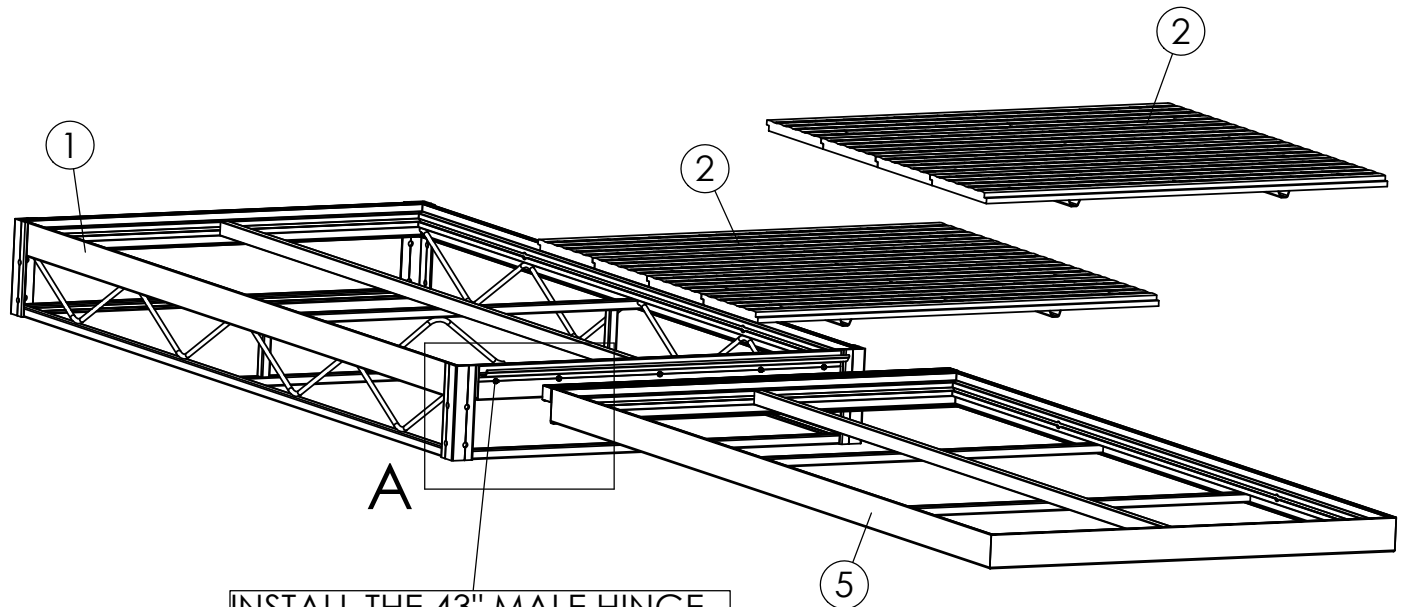

INSTALL THE 43" MALE HINGE  
ON THE STARTING END OF  
THE SECTION USING THE  
PROVIDED TEK SCREWS

Part #:	175-91095	Description:	Ramp, 4' x 8' : Titan Panels
---------	-----------	--------------	------------------------------



## Dock Ramps

The perfect approach to your dock, as well as the most cost effective way to add length. The shore-end ramp attaches using the Pier Pleasure hinge system. It pivots up and down and easily detaches for seasonal storage.

### Mushroom Titan

175-91090 4' x 4' Ramp with Titan Vinyl Panel

175-91095 4' x 8' Ramp with Titan Vinyl Panels

### Gray Titan

175-91290 4' x 4' Ramp with Titan Vinyl Panel

175-91295 4' x 8' Ramp with Titan Vinyl Panels

175-92090 4' x 4' Ramp with Cedar Panel

175-92095 4' x 8' Ramp with Cedar Panels



## Benches

Enjoy the day while resting on your Pier Pleasure bench. The aluminum frame with slanted backrest and plank seating provide a comfortable place to relax and enjoy your dock.

175-98020 Tan Vinyl Bench

178-98025 Gray Vinyl Bench



## Bench Arm Rests

Add a pair of Bench Arm Rest to hold your drink while enjoying your warm afternoon.

ACBNCH-ARMRSTVT Tan Vinyl Bench Arm Rests



## Accessories Attached to Inside Track

Several roll-in accessories attach to the frame using the inside track. The provided plates lock into the track allowing the accessory to be placed in any desired location. Accessories that use the inside track include: **Benches, Ladders, Canoe Rack, and Vertical Bumpers**

## Bench Canopies

A bench canopy will provide cool comfort while you relax on your bench.

ACBNCH-CNPY Bench Canopy Frame

CS-BENCH Seamark Fabric Bench Tarp

Available in Hemlock Tweed (Green), Dubbonet Tweed (Burgundy), Linen Tweed (Tan), Cadet Gray and Royal Blue Tweed.

CV-BENCH Vinyl Bench Tarp

Available in Green, White, Gray, Blue and Tan



## Ladders

The all-aluminum ladder extends high above the dock for enhanced leverage when climbing out of the water.

175-98010 3 Step Ladder

175-98015 4 Step Ladder

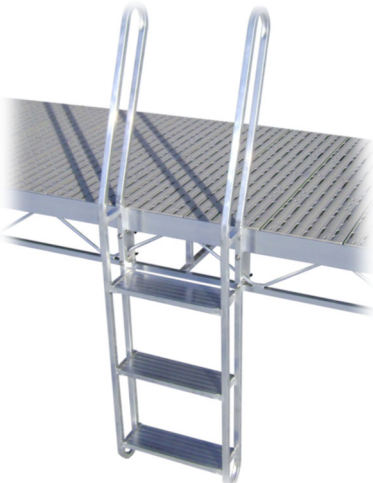

## Canoe Rack 175-98060

The canoe rack makes storage of your canoe or kayak simple. The canoe is at the water – ready to go when you are.



## 4' Vertical Bumper : Adjustable Height

Protect your boat. The vertical bumper is sturdy, holds the boat away from the dock and is easy to tie to. Adjust the height as the water fluctuates.

175-98050 4' Adjustable Vertical Bumper



**All accessories that attach to the Pier Pleasure Sectional Dock will also attach to the Roll-In Dock.**



## Accessories Using Dock Accessory Bracket

Several roll-in accessories attach to the dock using a carriage bolt through the dock accessory bracket. Accessories that use the bolt and dock accessory brackets are the **Movable Cleats, Dock Stairs, Dock Railings, Windsock Pole and Flagpole Bracket.**

### Dock Accessory Bracket ACBRKT

The bolt-on bracket allows for unlimited possibilities of accessories to be added to the dock. If you don't see what you need, create your own idea with this bracket.



## Movable Cleat

ACCLT-ASMBY 6" Cleat

ACCLT-ASMBY-10 10" Cleat

Place these aluminum cleats in any location on the dock. Easily move the cleat as needed.



## Dock Stairs

Safe access in and out of the water for young children and older adults. Adjustable for your lake bottom with drop legs that can be easily adjusted.

ACSTEP5 Dock Stairs : 5 Steps

ACSTEP6 Dock Stairs : 6 Steps

ACSTEP7 Dock Stairs : 7 Steps

ACSTEP8 Dock Stairs : 8 Steps

## Dock Railings

Add safety to your dock for children and older adults. Standard with 2 rails. An additional rail is available. Constructed of aluminum with a powder-coated finish to keep your hands and clothes clean.

ACRAIL8 8' Dock Railing

ACRAIL4 4' Dock Railing





## Windsock Pole

Display your favorite windsock on the easy to remove fiberglass telescoping windsock pole.

ACPWS-18 Windsock Pole : Fiberglass

ACPWS-MOUNT Windsock Dock Mount



## Flagpole

Display your flags on this premium twist-lock aluminum telescoping flagpole.

ACPFEC-20 20' Telescoping Twist-Lock Flagpole

175-98070 Flagpole Mounting Bracket : Roll-In



**All accessories that attach to the Pier  
Pleasure Sectional Dock will also attach to  
the Roll-In Dock.**

## Shore End Hitch 175-98005

Use your ATV, garden tractor or any vehicle with a ball hitch to maneuver your Roll-In dock system. Attach to the start of your dock with the provided fasteners. Using the provided bolts, clamp the hitch at the start of the section under the fram



## Corner Bumper

Protect your investment by installing bumpers on the corner of the dock. Using aluminum pop rivets, corner protectors can be added for protecting your boat.

175-41080 Corner Protector

140-18-68-RIV Rivet (4 Rivets per Bumper)



## Fishing Rod Holder

ACBRKT-POLE Pole Bracket, 1.5" Inside Diameter  
ACRODHLR Fishing Rod Holer

**(Net not included)**

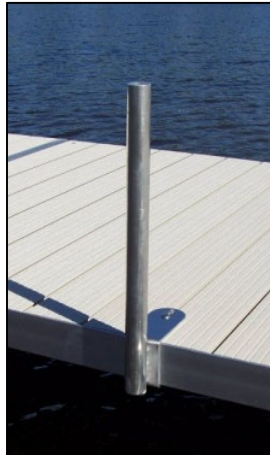

## Solar Lites

ACBRKT-DCKLITE 2" x 2" Flush Mount Bracket

ACBRKT-DCKLITE-12 2" x 2" :  
12" Tall Mount Bracket

ACLITE-SQ Solar Dock Lite : Fits 2" x 2" Tube



**All accessories that attach to the Pier  
Pleasure Sectional Dock will also attach to  
the Roll-In Dock.**

## Wedge Section

Use the wedge section to create an angled slip for more dock surface. This give you more access to additional boat lifts.

### Mushroom Titan

175-91170 Wedge Section : Titan Surface : Left

175-91180 Wedge Section : Titan Surface : Right

### Gray Titan

175-91370 Wedge Section : Titan Surface : Left

175-91380 Wedge Section : Titan Surface : Right

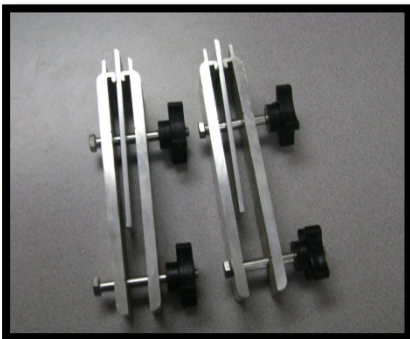
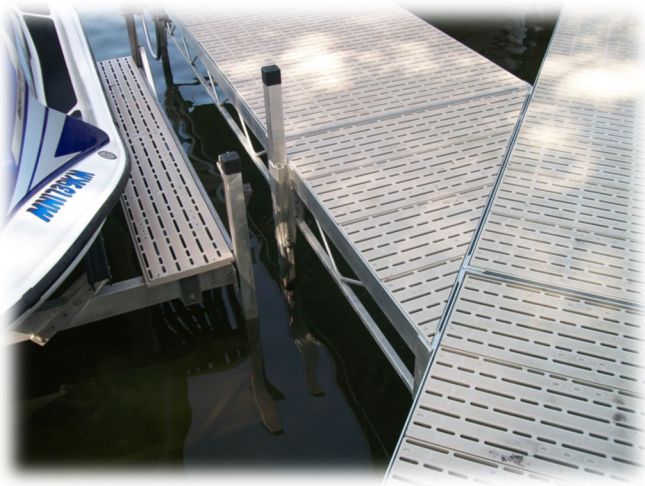



# PIER PLEASURE DOCK LIMITED WARRANTY

During the term of the Limited Warranty on your Pier Pleasure Dock, Pier Pleasure's obligations and liabilities under this warranty are limited to covering the cost of all parts and labor needed to repair or replace any Pier Pleasure supplied item that proves defective in material, workmanship or factory preparation. These repairs or replacements (parts and labor) will be made by your dealer using new or remanufactured parts for the periods specified for each product as follows:

<b>20-Year Dock Structural Limited Warranty</b>	
Sectional Dock Frames	20 Years
Sectional Dock Leg Kits	20 Years
e-Dock Sectional Dock Frames	20 Years
e-Dock Sectional Leg Kits	20 Years
Roll-In Dock Frames	20 Years
Roll-In Dock Wheel Kits	20 Years
<b>Lifetime Leg Adjustment Rod Limited Warranty</b>	
Sectional Dock Adjustment Rod Assembly	Limited Lifetime
Roll-In Dock Adjustment Rod Assembly	Limited Lifetime
<b>2-Year Dock Accessory Limited Warranty</b>	
All Dock Accessories	2 Years
<b>Vinyl Dock Surface Panel Limited Warranty</b>	
DockDeck by Trusscore®, formerly known as Brock Dock Vinyl Materials	Limited Lifetime
<a href="https://trusscore.com/resources/dockdeck-lifetime-limited-warranty.pdf">https://trusscore.com/resources/dockdeck-lifetime-limited-warranty.pdf</a>	
DockDeck Vinyl Panel Construction	12 Years
<b>Cedar Dock Surface Panel Limited Warranty</b>	
Cedar Panel Construction	1 Year
Cedar Deck Material	90 Days
<b>Aluminum Surface Panel Limited Warranty</b>	
Aluminum Panel Construction	5 Years
Aluminum Panel Paint	5 Years
<b>Titan Vinyl Surface Panel Limited Warranty</b>	
Titan Vinyl Panel Material	12 Years
Titan Vinyl Panel Construction	12 Years
VoyageR Aluminum	
<a href="http://www.titandeck.net">http://www.titandeck.net</a>	

The construction and material for each individual surface panel is covered by the supplier's limited warranty and/or Pier Pleasure's Limited Warranty. The warranty will vary in time for each dock surface.

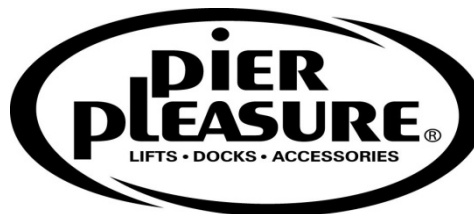

## Commencement of Warranty

The Pier Pleasure Limited Warranty will commence the earlier of 1) the date the original owner takes delivery of a new Pier Pleasure dock, OR (2) the date the dock was first put into service (for example, as a dealer "demo" or as a Pier Pleasure display dock).

## **Warranty not Transferable or Assignable:**

This Pier Pleasure Limited Warranty shall extend only to the original owner of our product and is not transferrable or assignable. The "original owner" is defined as the first legal owner of a Pier Pleasure Dock other than an authorized distributor or dealer who has bought the dock from Pier Pleasure for resale to the public.

## **What your Pier Pleasure Limited Warranty**

**Does Not Cover:** Your Pier Pleasure Limited Warranty does not cover the costs of repairing damage caused by environmental factors or Acts of God.

"Environmental factors" include, but are not limited to, such things as airborne fallout, chemicals, tree sap, salt, brackish water, galvanic corrosion, electrolysis and water hazards. "Acts of God" include, but are not limited to, such things as rainstorms, hailstorms, windstorms, tornadoes, lightning, floods and earthquakes.

Your Pier Pleasure Limited Warranty does not cover ice damage. Do not leave any Pier Pleasure product in the water during winter months. Leaving any Pier Pleasure product in freezing water in all situations is not recommended. **ANY LIABILITY FOR DEFECTS OR DAMAGES CAUSED BY LEAVING PRODUCT IN FREEZING WATER WILL NOT BE COVERED UNDER THIS WARRANTY.**

Your Pier Pleasure Limited Warranty does not cover the costs of repairing damage caused by poor or improper maintenance. The Pier Pleasure Limited Warranty does not cover the costs of normal or scheduled maintenance of your aluminum Pier Pleasure dock.

Your Pier Pleasure Limited Warranty does not cover the costs of repairing damage or conditions caused by fire or accident; by exceeding load ratings; by abuse or

**Register your Pier Pleasure purchase at  
[www.pierpleasure.com/warranty](http://www.pierpleasure.com/warranty)**

negligence; by misuse; by improper installation or removal; by tampering with parts; by improper adjustment or alteration; or by any changes made to your Pier Pleasure dock that do not comply with Pier Pleasure specifications.

The Pier Pleasure Limited Warranty does not cover commercial use applications of any Pier Pleasure product.

**Dock Modification or Alteration:**

Unauthorized modifications or alterations of, or use of components other than genuine Pier Pleasure components, on any Pier Pleasure products are not recommended. ANY LIABILITY FOR DEFECTS OR DAMAGES CAUSED BY SUCH UNAUTHORIZED MODIFICATIONS OR ALTERATIONS OF, OR USE OF COMPONENTS OTHER THAN GENUINE PIER PLEASURE COMPONENTS, WILL NOT BE COVERED UNDER THIS WARRANTY.

**Production Changes:**

Pier Pleasure and its distributors and dealers reserve the right to make changes in Pier Pleasure docks built and or sold by them at any time without incurring any obligation to make the same or similar changes on docks previously built and or sold by them, including with regard to any warranty repairs or replacements and this Pier Pleasure Limited Warranty does not cover the cost of adding anything to any Pier Pleasure product once it is delivered to the original owner.

**Disclaimers:**

THE LIMITED WARRANTY SET FORTH HEREIN IS IN LIEU OF ALL OTHER WARRANTIES AND LIABILITIES WHETHER IN CONTRACT OR IN TORT, NEGLIGENCE, EXPRESSED OR IMPLIED, IN LAW OR IN FACT, INCLUDING IMPLIED WARRANTIES OF MERCHANTABILITY AND FITNESS FOR A PARTICULAR USE. SOME STATES DO NOT ALLOW LIMITATIONS ON HOW LONG AN IMPLIED WARRANTY LASTS, SO THE ABOVE LIMITATION MAY NOT APPLY TO YOU.

TO THE MAXIMUM EXTENT PERMITTED BY LAW, PIER PLEASURE SHALL NOT BE LIABLE FOR ANY COSTS, LOSS, EXPENSE, DAMAGES, SPECIAL DAMAGES, INCIDENTAL DAMAGES OR CONSEQUENTIAL DAMAGES ARISING DIRECTLY OR INDIRECTLY FROM THE INSTALLATION, USE, MISUSE, OR INABILITY TO USE THIS PRODUCT. THIS EXCLUSION APPLIES REGARDLESS OF WHETHER SUCH DAMAGES ARE SOUGHT BASED

ON BREACH OF WARRANTY, BREACH OF CONTRACT, NEGLIGENCE, STRICT LIABILITY IN TORT, OR ANY OTHER LEGAL THEORY. SHOULD THE COMPANY NEVERTHELESS BE FOUND LIABLE FOR ANY DAMAGES, THE TOTAL LIABILITY OF THE COMPANY SHALL BE LIMITED TO THE PURCHASE PRICE OF THE PARTICULAR PRODUCT AT ISSUE. SOME STATES DO NOT ALLOW THE EXCLUSION OR LIMITATION OF INCIDENTAL OR CONSEQUENTIAL DAMAGES, SO THE ABOVE LIMITATION OR EXCLUSION MAY NOT APPLY TO YOU.

THIS WARRANTY GIVES YOU SPECIFIC LEGAL RIGHTS, AND YOU MAY ALSO HAVE OTHER RIGHTS WHICH VARY FROM STATE TO STATE.

**How to Get Warranty Service for Your Dock**

Please contact the dealer from whom you bought the dock for warranty service. When contacting your dealer, please provide them with your date of purchase and the nature of the problem. If contact with the dealer is not feasible, please contact Pier Pleasure for further assistance.

Pier Pleasure reserves the right to have dealers conduct any necessary warranty service. Dealers and Pier Pleasure, at their sole discretion, reserve the right to have defective parts returned for inspection as part of the warranty claim process. Pier Pleasure does not cover the cost of returning parts.

Thank you for the investment you have made in this Pier Pleasure product. This document contains Pier Pleasure, Inc.'s Limited Warranty. It should be kept in a safe place and presented to your dealer if any warranty service is needed.

Manufactured by:  
Pier Pleasure, Inc.  
1270 N River Drive  
Mankato, MN 56001  
Phone 800.658.7010  
[www.pierpleasure.com](http://www.pierpleasure.com)

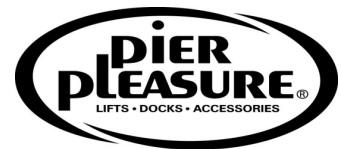

January - 2023

**All visual representations, dimensions, and specifications contained in this manual are based on the latest product information available at time of publication approval. The right is reserved to make changes in material, equipment, design, and specifications**

**Register your Pier Pleasure purchase at  
[www.pierpleasure.com/warranty](http://www.pierpleasure.com/warranty)**

All visual representations, dimensions, and specifications contained in this manual are based on the latest product information available at time of publication approval. The right is reserved to make changes in material, equipment, design, and specifications.

Dock layouts shown in this manual may not meet local and state codes in your area.

Pier Pleasure's warranty does not cover wind, storm, or ice damage. Do not leave any Pier Pleasure product in the water during winter months. Any liability for damages caused by leaving product in freezing water will not be covered under warranty.



1270 N River Drive • Mankato, MN 56001  
Phone 800.658.7010 • [www.pierpleasure.com](http://www.pierpleasure.com)

